

FEATURES

1. Splay terminals allow for automatic insertion by IC insertion machine.
2. Straight terminals are available for manual insertion.
3. Insert molding of terminals and ultrasonic welding improve flux proofness and enable flux washing in whole by top tape sealing.
4. NDI series (raised actuator) and NDIR series (recessed actuator) available for different purposes.
5. Double contacts offers high reliability.
6. Vapor phase solderable, IR-reflow solderable.

SPECIFICATIONS

CONTACT RATING: 25mA @24 VDC (switching Rating)
 100mA @50VDC(non-switching Rating)
 ELECTRICAL LIFE:2000 operations min. @ 24VDC,25mA
 CONTACT RESISTANCE: 50 mΩ max. initial
 INSULATION RESISTANCE: 100 MΩ min. at 500 VDC
 DIELECTRIC STRENGTH: 500 V AC /1 min
 OPERATION FORCE: 1000 gf max
 STORAGE TEMPERATURE: -40°C to 85°C
 CIRCUIT: SPST

MATERIALS

COVER: UL94V-0 PPS, Thermoplastic(Black)
 BASE: UL94V-0 PPS, Thermoplastic(Black)
 ACTUATOR: UL94V-0 Nylon, Thermoplastic(white)
 CONTACT PLATING: Gold plating over nickel
 TERMINAL PLATING: Gold plated

CONTACT SYSTEM OF NDI(R) & DM(R) SERIES

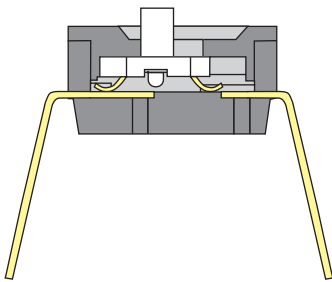

NDI(R) SERIES

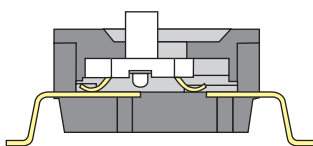

DM(R) SERIES

DIMENSIONS

NDI(R)

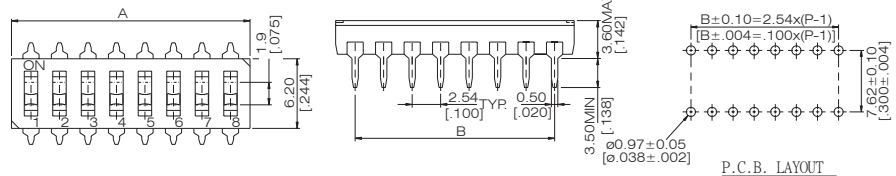

DM(R)

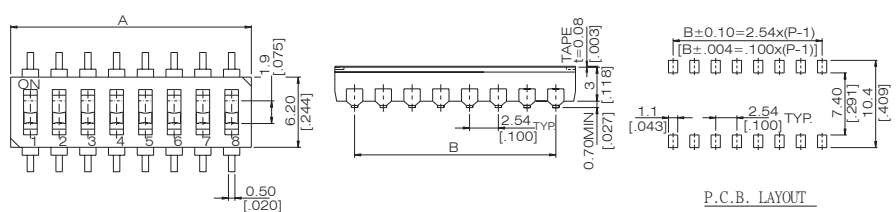

TERMINAL TYPE

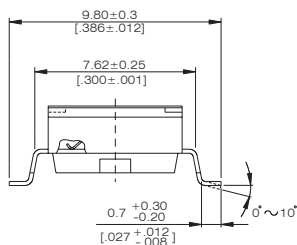

DMR SERIES

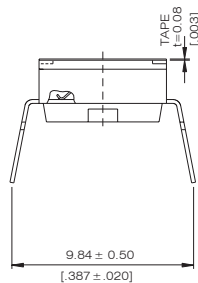

NDIR - □□ S

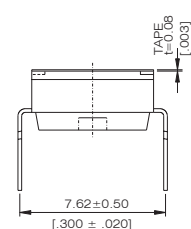

NDIR - □□ H

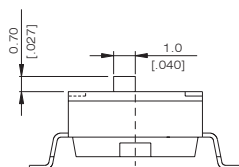

DM SERIES

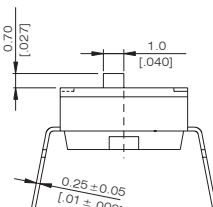

NDI - □□ S

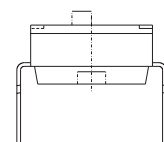

NDI - □□ H

General Tolerance: ±0.2mm(±0.008")

INDEX TOGGLE ROCKER SLIDE PUSH BUTTON DIP TACT

SOLDERING AND CLEANING PROCESSES

- △ Keep all switch contacts in their "OFF" position for all operations.
- △ WAVE SOLDERING: Recommended solder temperature at 500 °F (260 °C) max. 5 seconds. □ For through hole type.
- △ HAND SOLDERING: Use a soldering iron of 30 Watts controlled at 350 °C approximately 5 seconds. □ while applying solder.

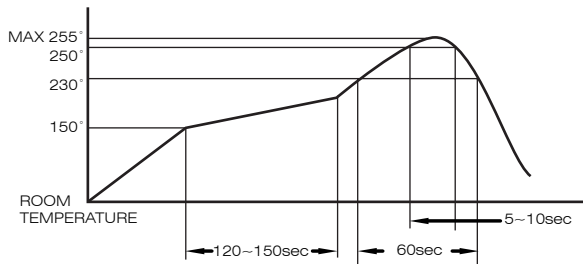

- △ Reflow Temperature Profile.
- △ Care should be exercised so that flux from the upper part of the printed circuit board does not adhere to the switch.
- △ Do not clean the switch body except with top tape sealed type, which can only spray of cleaning method from top s/w.

HOW TO ORDER

□ □ □ □ - □ □ □ - □ □ - □ □ - □ □

- RoHS code
H = RoHS Compliant
- ▲ Package Style
□ = Tube
T/R = Tape & Reel
< ▲ T/R Only For DMR Except DMR-01 >
- ▲ SEAL:
□ = Regular
T = Top Tape Sealed
- Number Of Positions:
01 = 1 Positions
02 = 2 Positions
03 = 3 Positions
04 = 4 Positions
05 = 5 Positions
06 = 6 Positions
07 = 7 Positions
08 = 8 Positions
09 = 9 Positions
10 = 10 Positions
12 = 12 Positions
- Actuator Type:
□ = Raised Actuator
R = Recessed Actuator
- Shape Of Terminal:
□ = Regular (only for DM series)
S = Splay Terminal
H = Straight Terminal
- NDI = Machine Insertable Type Dip Switch
DM = Surface Mounting Type Dip Switch

MODELS

DM - 12 DMR - 12	NDI - 12 NDIR - 12	12	31.42[1.237]	27.94[1.100]
DM - 10 DMR - 10	NDI - 10 NDIR - 10	10	26.34[1.037]	22.86[.900]
DM - 09 DMR - 09	NDI - 09 NDIR - 09	9	23.80[.937]	20.32[.800]
DM - 08 DMR - 08	NDI - 08 NDIR - 08	8	21.26[.837]	17.78[.700]
DM - 07 DMR - 07	NDI - 07 NDIR - 07	7	18.72[.737]	15.24[.600]
DM - 06 DMR - 06	NDI - 06 NDIR - 06	6	16.18[.637]	12.70[.500]
DM - 05 DMR - 05	NDI - 05 NDIR - 05	5	13.64[.537]	10.16[.400]
DM - 04 DMR - 04	NDI - 04 NDIR - 04	4	11.10[.437]	7.62[.300]
DM - 03 DMR - 03	NDI - 03 NDIR - 03	3	8.56[.337]	5.08[.200]
DM - 02 DMR - 02	NDI - 02 NDIR - 02	2	6.02[.237]	2.54[.100]
DM - 01 DMR - 01	NDI - 01 NDIR - 01	1	3.48[.137]	—
PROD. NO.		NO. OF POS.	DIM. A	DIM. B
SCHEMATIC(TYP.)				
(1,2,3,4,5,6,7,8,9,10,12, POS AVAIL)				